

Scribner Rd

Dutchman Ct

Blue Moon Rd

Mill Rd

South Forestvale No. 2 Sub. RID

Crescent Moon Dr

Green Meadow Dr

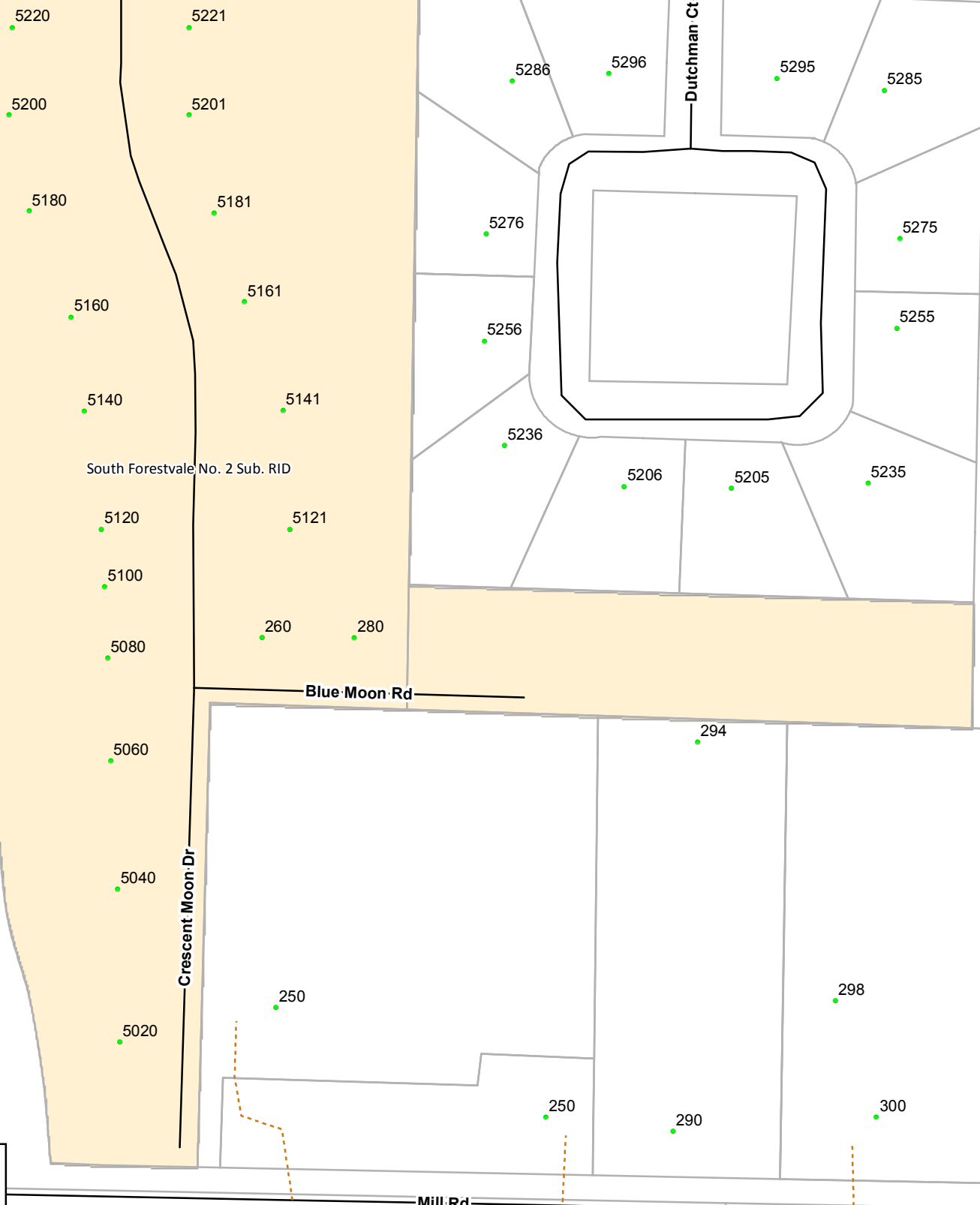

County RIDs  
 Address Points  
 Parcel Boundaries

**Roadways**

PAVED  
 UNPAVED  
 DRIVEWAY  
 ONEWAY  
 ONEWAY  
 Railroads

## Lewis & Clark County Road Improvement Districts

### South Forestvale No. 2 Sub. RID

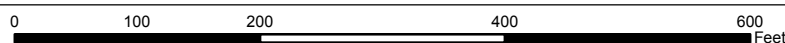

Document Path: G:\\_ArcProjects\IRIDs\_county\_MapSeries8x11.mxd  
 Date Saved: 9/30/2015 5:00:28 PM



CITY OF HELENA - LEWIS & CLARK COUNTY  
 GEOGRAPHIC INFORMATION SERVICES  
 Room 207 City-County Building  
 316 N PARK AVE  
 HELENA, MONTANA 59624  
 406-447-8389  
[www.lccountymt.gov/gis](http://www.lccountymt.gov/gis)